



Agricultural Property in Thano Village Distt. Dehradun

About Village Thano...



Thano is a village situated in **Raipur Block of Dehradun** district in Uttarakhand and is full of greenery. It is one of the **111** villages of Raipur Block. **The village has 28 houses.** Literacy rate in Thano village is **71%.**

The weather of the place is mild and the average **temperature throughout the year is around 21 degree** Celsius being placed at an elevation of **648 mtrs (2100 ft.)** above the sea level.

About The Property...



- This is an agricultural property with a house (old construction) and a Cow Ranch (Gaushala). It is located in Thano village, distt. Dehradun (Uttarakhand).
 - The total land area of the property is: **6.25 Bigha/5,625 Sq. Yards/ 1.2 Acres.**
 - **The main advantage of the property is its placement . It is only half an hour drive from the Yoga Capital of the world “Rishikesh” and at the same distance from the Capital of Uttarakhand “Dehradun”.**
 - **Haridwar , the long known “Holy City” of India and a Kumbh Mela destination is also at 45 Minutes drive.**
 - **Also it is very close (5 minutes drive) to the airport which gives it a great commercial use too.**
 - **Mussoorie , Dhanaulti and nearby Hill stations are also very much connecte3d to this area with wide roads , Flyovers and bridges coming in the surrounding areas thus saving a lot of travel time .**
 - **The road that leads to the land from the airport is one of the most beautiful in the area. Passing through the dense forest region for almost 5 Kms.**
(See Picture)
- 
- **In case of a retreat/Hotel the cow Ranch area can be utilized for a yoga Hall/ Conference Hall / Dining Area or other purposes.**
 - **The best material has been used for the construction. Even one more floor can be put up on the existing construction.**

Lay Out plan of the property...

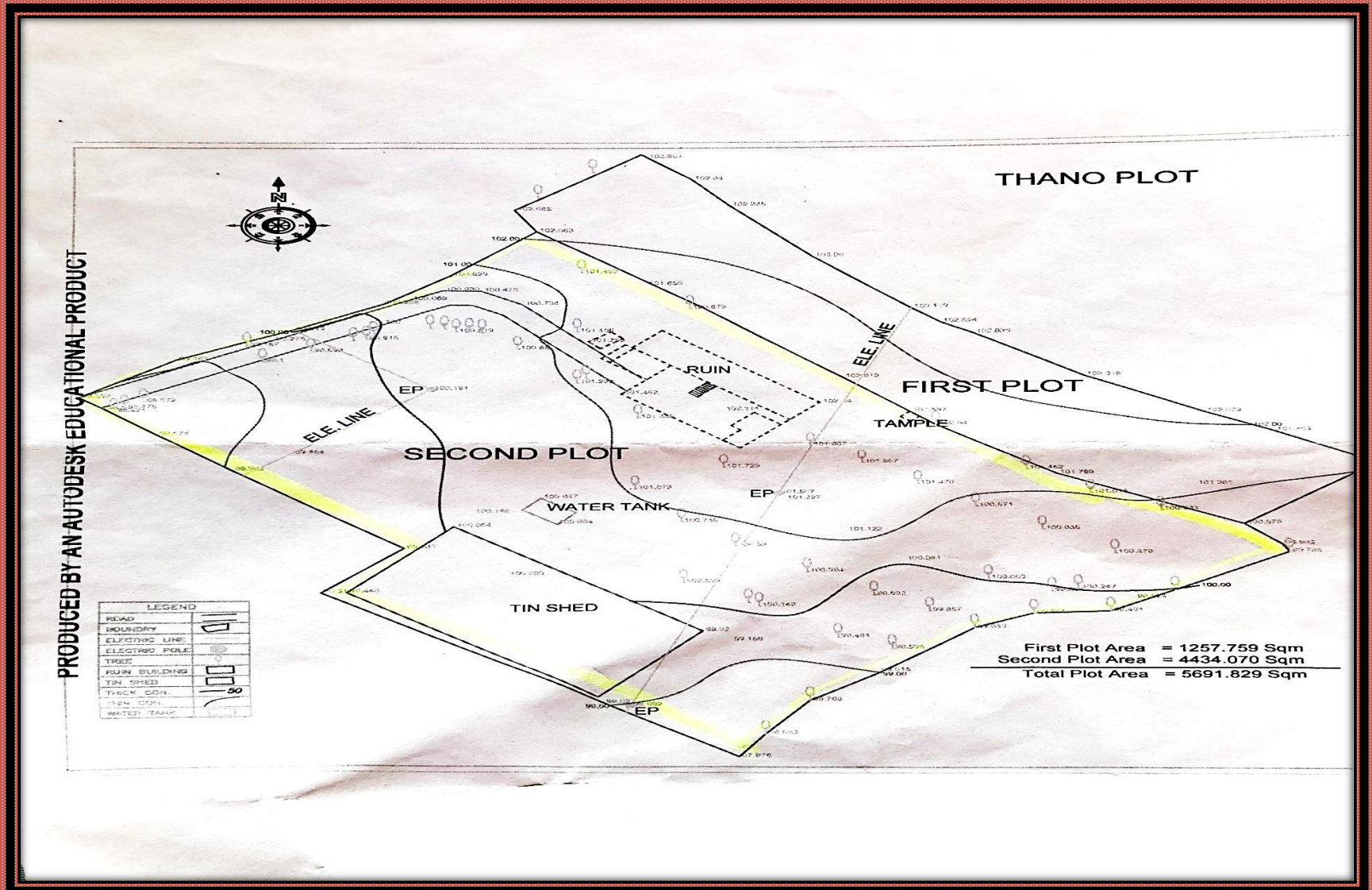

Google Map View...



Distance from main road – 100 Mtrs.

Pictures of the property...



The old House

Pictures of the property...



View of link road

Pictures of the property...



Close view of the old house



Pictures of the property...



View of Cow Ranch

Picture of the property...



Mango Trees



Bamboo Trees



Trees on the property

Points to note...



- **TOTAL LAND AREA** : **6.25 BIGHA/ 5,625 SQ.YARDS/ 1.20 ACRES**
- **LOCATION ADVANTAGES** : **JOLLY GRANT AIRPORT – 6.0 Kms.**
THANO CHOWK – 800 Mtrs.
RAIPUR, (DEHRADUN) – 18 Kms.
DEHRADUN (MAIN CITY) – 25 Kms.
RISHIKESH – 20 Kms.
CLOSE TO RAJIV GANDHI INTERNATIONAL CRICKET STADIUM
NEAR THE LAND OF A FIVE STAR HOTEL – ‘THE LALIT’
ON THE REAR SIDE, IT HAS A SEASONAL WATER SPRING .
PROPOSED – 4 LANE HIGHWAY (DDUN - AIRPORT ROAD)
- **CURRENT LAND USE** : **AGRICULTURAL (FREE HOLD PROPERTY)**
- **POSSIBLE USE** : **ASHRAM, YOGA RETREAT, SPA**
RETREAT, HOTEL, FARMING, HERBAL
FARMING, GAUSHALA, FARM HOUSE. etc

About Us...



- SATYAM PROPERTIES IS A FULL TIME REAL ESTATE MARKETING AND CONSULTANCY FIRM FOUNDED ABOUT 29 YEARS AGO BY SH. Y.R. GUPTA. UNDER HIS GUIDANCE THE FIRM HAS BEEN CONTINUOUSLY FULFILLING THE REQUIREMENTS OF ITS CLIENTS THROUGH ITS ESTEEMED SERVICES WITH FULL DEDICATION, INTEGRITY AND HONESTY, THEREBY PROVIDING THEM THE MAXIMUM SATISFACTION AND ZERO DISAPPOINTMENT. TODAY, THE FIRM IS BEING RUN BY SH. Y.R.GUPTA AND HIS SON MR. NIPUN GUPTA. THE FIRM PROVIDES THE REAL ESTATE SOLUTIONS IN RISHIKESH AND THE ADJOINING AREAS VIZ. HARIDWAR, DEHRADUN, MUSSOORIE, ROORKEE, NAINITAL, GANGOTRI ROUTE, BADRINATH ROUTE AND NEELKANTH ROUTE. WE ALSO PROVIDE SOLUTIONS IN DELHI - NCR AND OTHER AREAS ACROSS THE NATION. WE ARE COMMITTED TO:
- LEADERSHIP IN THE REAL ESTATE INDUSTRY.
- THE HIGHEST ETHICAL STANDARDS. UNCOMPROMISING HONESTY AND NTEGRITY.
- FAIR RETURN FOR OUR INVESTMENT, RISK AND EFFORTS.

- Contact us:-

MR. Y.R. GUPTA	-	+91- 9837089206
MR. NIPUN GUPTA	-	+91- 9837739933
LANDLINE	-	+91-135- 2431801

- ADDRESS: - SATYAM PROPERTIES, 42 SBM SHOPPING COMPLEX, HARIDWAR ROAD, RISHIKESH
- Website: - www.satyamproperties.com
- Email: - satyamproperties@yahoo.com



THANK YOU